

WCX SERIES

HURRICANE WALL SLEEVE

INSTALLATION INSTRUCTIONS

****WARNING TO INSTALLER, SERVICE PERSONNEL AND OWNER****

Altering the product or replacing parts with non authorized factory parts voids all warranty or implied warranty and may result in adverse operational performance and/or a possible hazardous safety condition to service personnel and occupants. Company employees and/or contractors are not authorized to waive this warning. Current **Maintenance Program** is available at www.firstco.com under "Product Information".

GENERAL

These instructions give information relative to the WCX Series Hurricane Wall Sleeve and Hurricane Grille installation only. The manufacturer assumes no responsibility for equipment installed in violation of any code requirements. For other related equipment refer to the proper instructions.

The grille and wall sleeve are shipped in separate packages. Material in this shipment has been inspected at the factory and released to the transportation agency in good condition. When received, a visual inspection of all cartons should be made immediately. Any evidence of rough handling or apparent damage should be noted on the delivery receipt and the material should be inspected in the presence of the carrier's representative. If damage is found a claim should be filed against the carrier immediately.

DESCRIPTION

The WCX Hurricane Wall Sleeve is designed to provide the structural support and seal from the outside elements for the WCX package system. There is no need to build a platform base for the WCX. The base of the sleeve also acts as the drain pan for the system. A 3/4 NPT nipple is located in the bottom of the pan to be connected to the condensate drain plumbing.

The WCX Hurricane Wall Sleeve is designed to be used in conjunction with the G210 Hurricane Grille only. Installation with any other grille will not meet applicable specifications.

LOCATION

The WCX unit is designed for through the wall installation in a closet with direct access to the rear of the unit (Fig. 1). The exterior (grille side) of the unit must have no obstructions (trees, landscape materials, or building structure, etc.) within 18 inches. Do not locate two units adjacent to each other on an inside corner or anyplace

where they may exhaust into each other.

Provisions should be made to allow for access to the indoor (rear) side of the unit for installation and inspection. A minimum of 27 inches of unobstructed space should be provided in front of the access door to permit removal of the unit should repair and inspection be required.

WALL SLEEVE INSTALLATION

1. Install the sleeve into a pre-cut opening 34-1/4"H x 25-1/2"W. Use shims as necessary to maintain proper alignment of the sealing surfaces. Sleeve sides must remain in contact with the seal frame and parallel with each other or air leakage will occur. Note: The factory applies a sealant to the outside of the interface between the seal and the sleeve. The installer is responsible to check this for damage due to installation and to add sealant as necessary to ensure that no air gaps exist.

******* Warning *******

After sleeve installation ensure that the sleeve seal is in contact with the sleeve sides. Any air gaps must be sealed or outdoor air and/or water leakage will occur.

2. The front edge of the sleeve should protrude 1/4" to 1/2" from the finished outside surface of the wall (Fig. 3).
3. Align the sleeve with the wall so that the bottom pan is angled 1/2 bubble toward the outside of the building (Fig. 3).

******* Warning *******

Ensure that the bottom of the sleeve pan is pitched toward the outside to ensure positive secondary drainage.

4. Fasten the sleeve to the wall studs at 3 locations on each side. Note: It is recommended to use fasteners with seal washers to minimize the possibility of water leakage into the wall.
5. Attach wall support brackets to each side of the wall sleeve as shown in Fig. 1. Adjust brackets so that the flange is in contact with the inner surface of the wall and tighten bolts.
6. Place a bead of silicone sealant or other high grade non-hardening sealing compound approved for exterior use to seal the gap between the wall sleeve and both the inside and outside wall surfaces (Fig. 3). Sealant should also be applied around the heads of the fasteners used to secure the sleeve.

******* WARNING *******

Application of the sealant to both inside and outside surfaces of the sleeve is critical to prevent infiltration of outside elements from entering the structure.

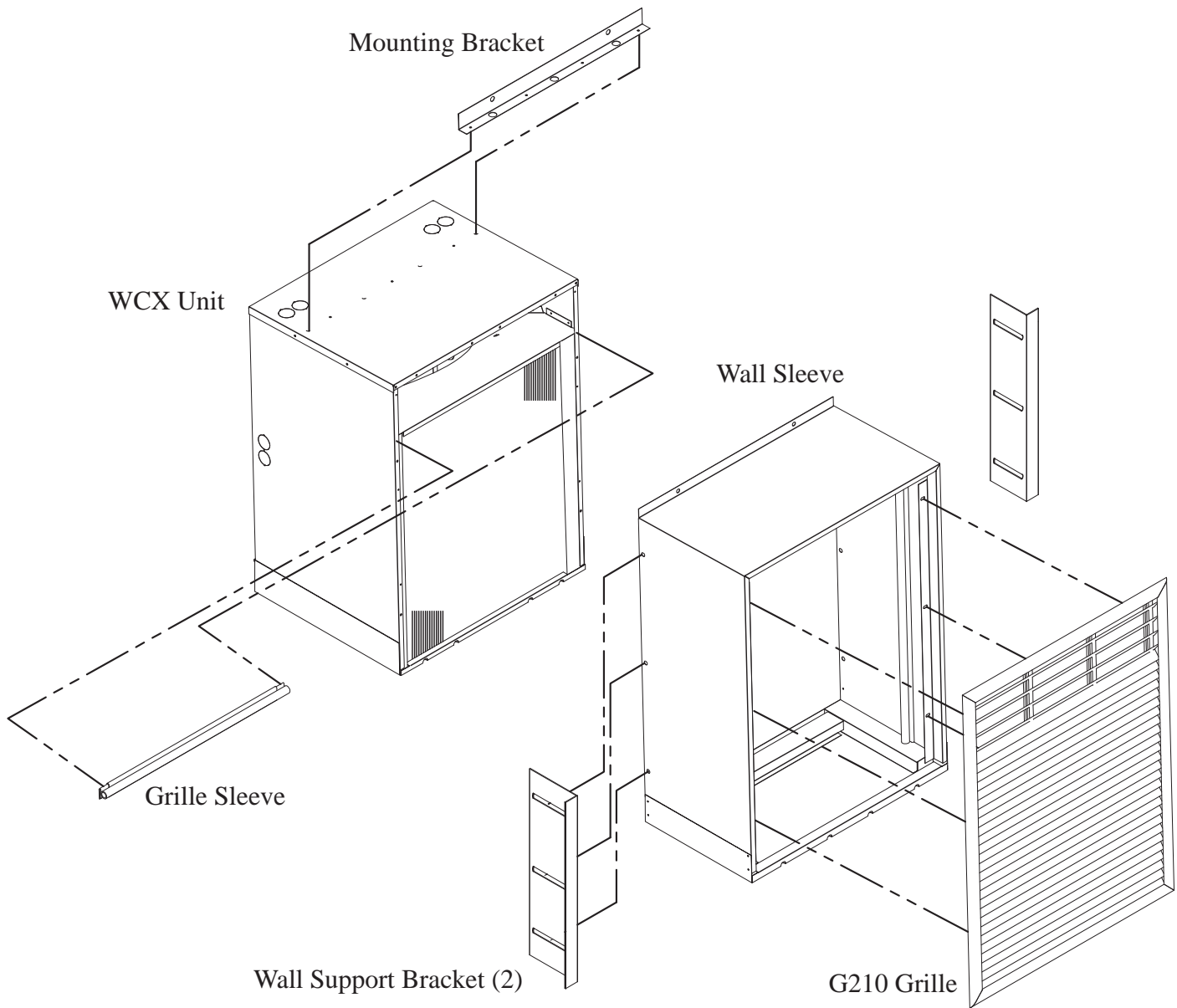

Figure 1

******* WARNING *******

The Architectural Grille must be installed prior to the installation of the WCX unit into the sleeve.

GRILLE INSTALLATION

1. Install 6 threaded studs into the threaded holes in the grille. Note: Studs, nuts and washers may be attached to the grille or may be found in bulk packaging with the grille shipment.
2. Insert the threaded studs into the slotted holes in the wall sleeve. Place the provided aluminum strip onto the threaded studs of the grille after installation into the sleeve and before attaching the nuts.

3. Secure grille with a washer and 10-32 nut on each stud.

WCX INSTALLATION

1. Remove Mounting Bracket and Grille Seal (they are attached together and mounted to the top of the sleeve) and separate the two pieces.
2. Attach the Mounting Bracket to the top of the WCX unit using 4 self drilling screws provided. Dimples are formed into the WCX top for location purposes.
3. Remove the wire grille from the front of the WCX unit and discard.
4. Attach the Grille seal to the front of the WCX unit as shown (figure 1) with 2 sheetmetal screws.
5. Install WCX unit into sleeve and secure the WCX unit through the mounting bracket with the 1/4-20 bolts.